



High Peak Borough Council

working for our community

**PUBLIC PATH DIVERSION ORDER
TOWN AND COUNTRY PLANNING ACT 1990 SECTION 257
THE HIGH PEAK BOROUGH COUNCIL
FOOTPATH 14 (PART) CHARLESWORTH
PUBLIC FOOTPATH DIVERSION ORDER JUNE 2017**

This order is made by the High Peak Borough Council under section 257 of the Town & Country Planning Act 1990 because it is satisfied that it is necessary to divert the footpath to which this order relates in order to enable development to be carried out in accordance with planning permission granted under Part III of the Town and Country Planning Act 1990 namely Proposed Engineering Operations consisting of Construction of a new access road and associated Landscaping at Land at Boggard lane, Charlesworth, planning ref: HPK/2015/0683.

BY THIS ORDER

1. The footpath number 14 over the land shown by a bold black line on the attached map and described in Part 1 of the Schedule to this order (the Schedule") shall be diverted as provided below.
2. There shall be created to the reasonable satisfaction of High Peak Borough Council an alternative highway for use as a replacement for the said footpath as provided in Part 2 of the Schedule and shown by bold black dashes on the attached map.
3. The diversion of the footpath shall have effect on the date on which High Peak Borough Council certify that the terms of Article 2 above have been complied with.
4. The following works shall be carried out in relation to the highway described in Part 2 of the Schedule: The diverted length of footpath between points A - C shall be two metres wide and surfaced with granular chippings.
5. Mr & Mrs S J Hartle of 7 Boggard Lane, Charlesworth Glossop are required to pay for the cost of carrying out the said works.
6. Where immediately before the date on which the footpath is diverted there is apparatus under, in, on, over, along or across it belonging to statutory undertakers for the purpose of carrying on their undertaking, the undertakers shall continue to have the same rights in respect of the apparatus as they then had.

SCHEDULE

PART 1

DESCRIPTION OF SITE OF EXISTING PATH OR WAY

Section indicated on Map A – B **The whole width and length of Footpath 14 from point A (400639,392468) proceeding in a generally easterly direction to point B (400649,392470). Points A to B in bold on the plan will be closed (approximately 6 metres).**

PART 2

DESCRIPTION OF SITE OF ALTERNATIVE PATH OR WAY

Section indicated on Map A- C **A 2 metre wide granular chippings surfaced footpath in the parish of Charlesworth from point A (400639,392468) and in a South easterly direction to point C (400656,392459) for a total distance of 14.5 metres or thereabouts.**

THE COMMON SEAL of the
HIGH PEAK BOROUGH COUNCIL
Was hereunto affixed this 13th day of
June 2017 in the presence of



Nicola de Bruin
SOLICITOR
For and on behalf of High Peak Borough Council

Diversion of Footpath 14 Boggard Lane Charlesworth

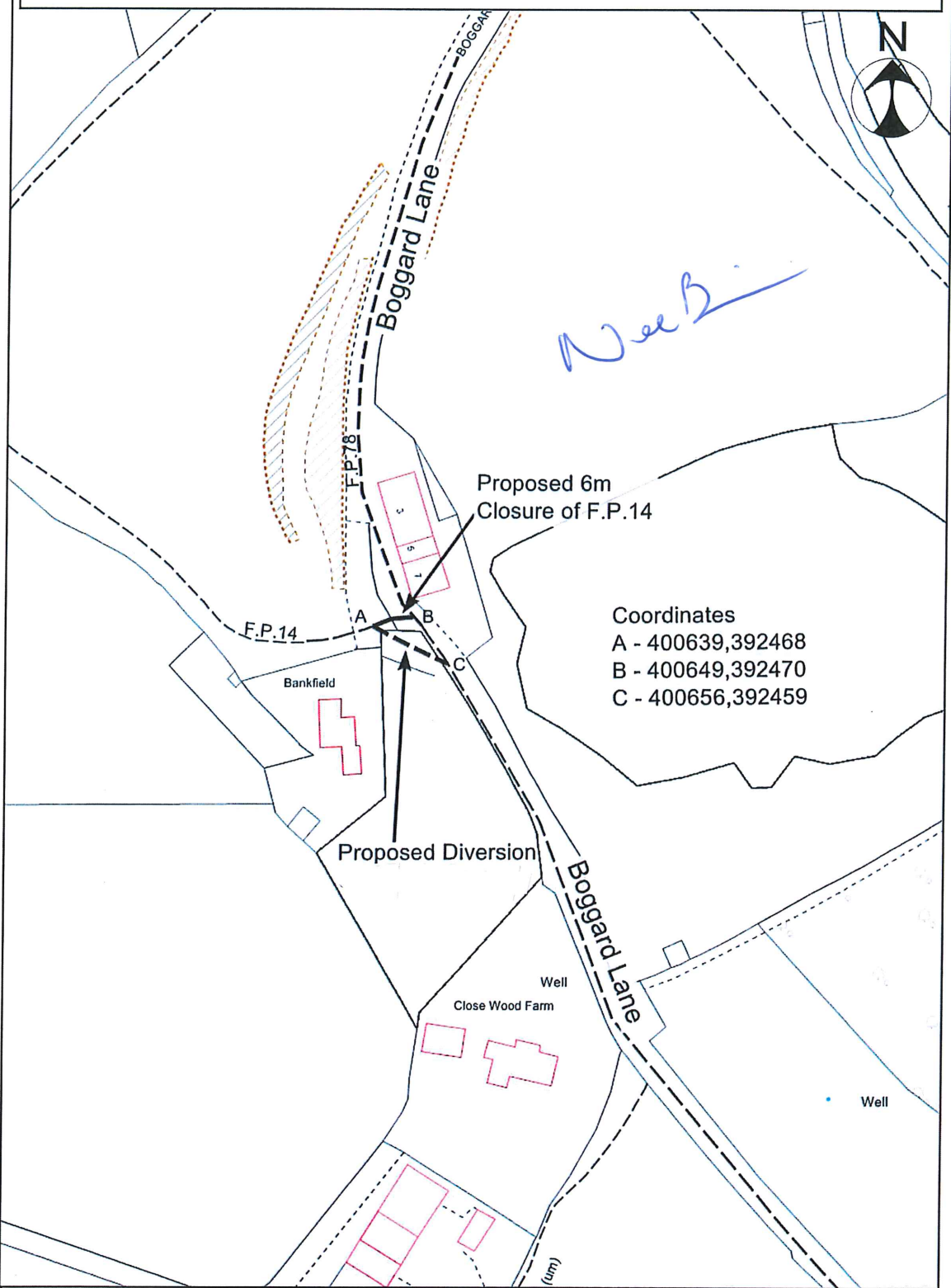

0 10 20 metres

Scale - 1:1250

© Crown copyright and database rights 2017 Ordnance Survey 100018384 Date: 18 January 2017