

**PUBLIC PATH DIVERSION ORDER
TOWN AND COUNTRY PLANNING ACT 1990 SECTION 257
THE HIGH PEAK BOROUGH COUNCIL
FOOTPATH 115 CHAPEL-EN-LE-FRITH
PUBLIC PATH DIVERSION ORDER 2017**

This order is made by the High Peak Borough Council under section 257 of the Town & Country Planning Act 1990 because it is satisfied that it is necessary to divert the footpath to which this order relates in order to enable development to be carried out in accordance with planning permission granted under Part 3 of the Town and Country Planning Act 1990 namely Proposed Engineering Operations consisting of construction of a new access road in relation to planning ref: HPK/2015/0380

BY THIS ORDER

1. The footpath number 115 over the land shown by a bold black line on the attached map (available for inspection during the usual office hours, at the Town Hall, Market Place Buxton Derbyshire SK17 1AQ) (marked A,B,) and described in Part 1 of the Schedule to this order (the Schedule") shall be diverted as provided below.
2. There shall be created to the reasonable satisfaction of High Peak Borough Council an alternative footpath for use as a replacement for the said footpath as provided in Part 2 of the schedule and shown by bold black dashes on the attached map (marked A,C,)
3. The diversion of the footpath shall have effect on the date on which High Peak Borough Council certify that the terms of Article 2 above have been complied with.
4. The following works shall be carried out in relation to the highway described in Part 2 of the Schedule: The new length of **footpath** between points A,C shall be two metres wide with a tarmacadam surface and edged.
- 5 Mrs Sally Ann Wilkinson and Ms Tracy Broomhead Warmbrook Barn, Chapel-en-le-Frith High Peak are required to pay for the cost of carrying out the said works.
- 6 Where immediately before the date on which the footpath is diverted there is apparatus under, in on, over along or across it belonging to statutory undertakers for the purpose of carrying on their undertaking, the undertakers shall continue to have the same rights in respect of the apparatus as they then had.

SCHEDULE

PART 1

DESCRIPTION OF SITE OF EXISTING PATH OR WAY

Section indicated on Map A – B

The whole width of footpath 115 as shown in bold on the enclosed map from point A (SK 0626 8041) and then in an east, south Easterly, then north, easterly direction for a distance of approximately 35 metres or thereabouts to point B (SK 0629 8042).

PART 2

DESCRIPTION OF SITE OF PROPOSED PATH OR WAY

Section indicated on Map A-C

A 2 metre wide tarmacadam surfaced Footpath in the Parish of Chapel-en-le Frith from point A (SK 0626 8041) proceeding in a generally east, north Easterly then north, north easterly direction for a distance of approximately 36 metres or thereabouts to point C (SK 0627 8042).

THE COMMON SEAL of the
HIGH PEAK BOROUGH COUNCIL
Was hereunto affixed this 15th day of
May 2017 in the presence of

For and on behalf of High Peak Borough Council

Continuation & Certification verified.



The foregoing Order is hereby confirmed.
Further, it is hereby certified that the
provisions of the above Order have been
complied with & the diversion of the
said footpath shall take effect on the
date hereof

No 23

8.1.2021

Authorized Signatory

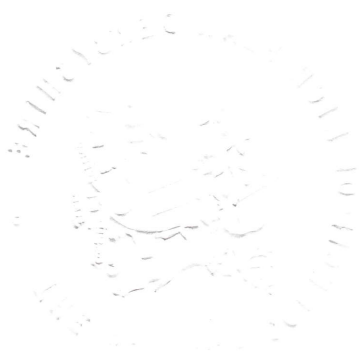

Chapel-en-le-Frith Public Footpath No 115 (Part)

Site Location plan Scale 1:2500 on A4

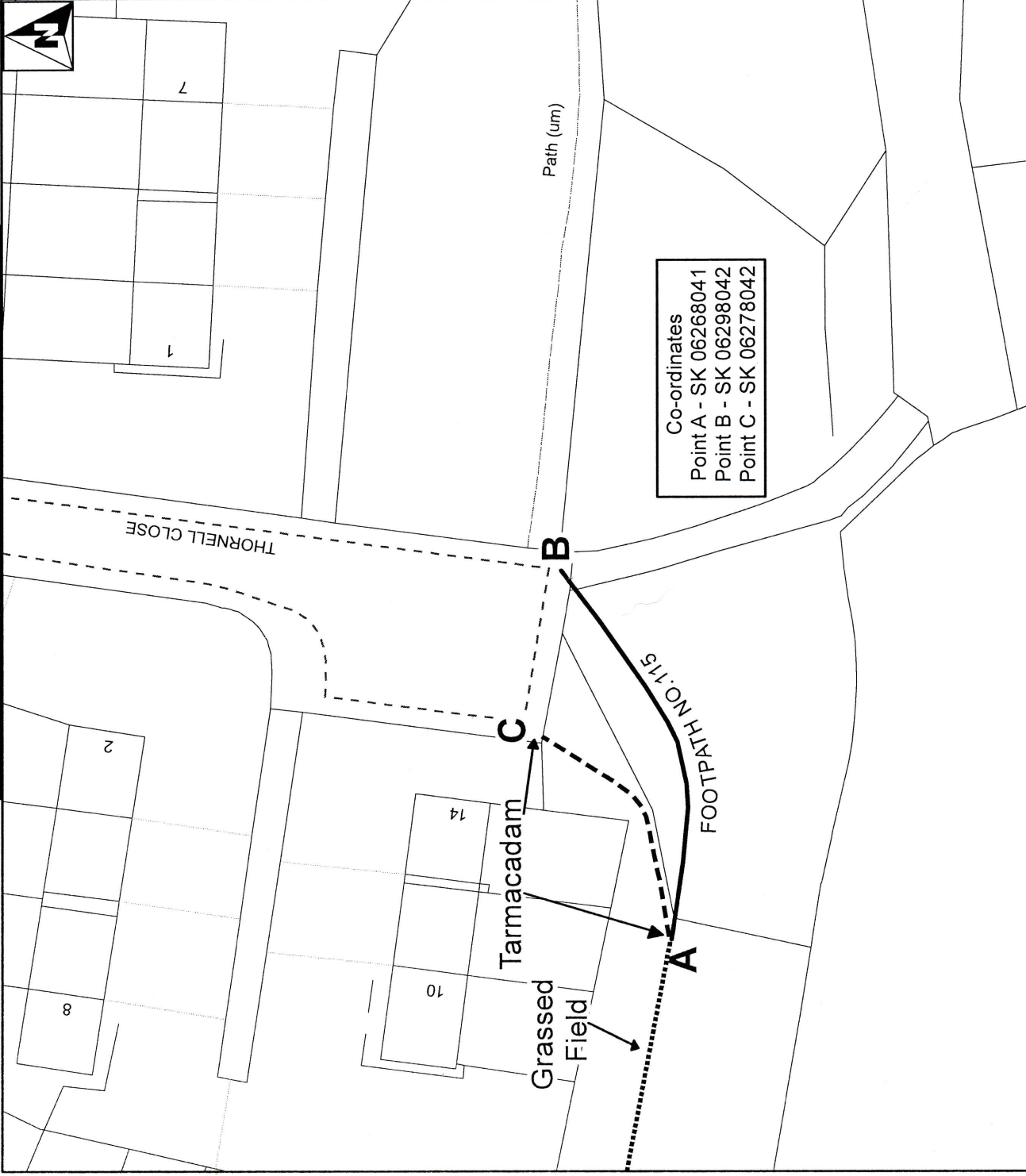

- Unaffected Footpath
- Part of footpath to be diverted
- - - - Alternative footpath